



Company News

公司動態

Promotion to Director – Ir Patrick Chu 晉昇公司董事 - 朱卓恒先生

Patrick graduated from the Hong Kong University of Science and Technology with honor degree in Mechanical Engineering in 2000. He holds a Master Degree in Building Services Engineering and has been a Chartered Engineer for nearly 10 years. He joined Talent as graduate trainee since his graduation in 2000. He worked as Assistant Engineer, Engineer, Project Engineer, Senior Project Engineer, Associate, Associate Director in the Company. Through years of relentless hard work and focusing on projects' and clients' needs, he garnered countless compliments and appreciations from project teams. He developed an analytical mind and handled projects cautiously at a very early stage of his career. Patrick has been taking part in setting the directions and policies of the company in recent years. This has eased our burden on the high demand on quality members for steering the company. His experiences cover office tower, hotel, research centre, large scale residential development, energy saving etc. and he specializes on formulation of M&E schemes and analytical studies. His promotion bolsters the capacity of our company's steering group, the trainings of our engineers and upkeeping the technology edges of our engineering team.



朱卓恒先生於2000年畢業於香港科技大學，獲機械工程榮譽學士學位，隨後獲取屋宇裝備工程學碩士學位及英國特許工程師資格凡十年之久。朱先生從畢業起便加入滙智作為受訓畢業生。並從助理工程師做起，經歷工程師、項目工程師、高級項目工程師、聯席董事、高級聯值董事等各職級。其過人的分析能力及謹慎的處事作風，經年累月的辛勤工作及專注於項目及業主的要求，已取得業主及項目團隊的信賴及好評。朱先生於近年參與公司的方向制訂及管理工作，這增強我們公司領導團隊的實力。朱先生的經驗涵蓋辦公樓、酒店、科研、大型住宅發展、節約能源等，專長於機電方案研究、定案及系統分析。他的晉昇鞏固了我們的領導團隊、工程師的培訓及保持我們同事們緊隨科技發展的優勢。

Keeping Abreast of New Technology 與新科技並肩前行



Advancement in Technology, in particular, computer science and information technology, have been bringing the upheaval on our daily lives. Artificial Intelligence & Deep Learning, Big Data, IoT, Edge Computing, Smart City are the current hot topics and bring about an unpredictable outcome in the future. M&E engineering, seems not directly related to the change, cannot evade from the impact. Pursuing to the

studies on 11 topics we had carried out in 2018, we deepened our studies in 2019 covering another 14 topics including 5G technology and its applications to Building Services Industry, Authorizing Control to End Users in Buildings, Machine Learning & AI in Buildings etc. Smart thermostats, energy metering sockets using radio frequency for transmitting data and others were purchased and used for studying the limitations and benefits for extensive applications.

Again, this continuing studies and learning can keep us abreast of the new technology. Studies were carried out in groups for 4-6 months. Results of the studies, findings and analyses were presented to other colleagues with the materials and the results uploaded in our server for sharing and retrieval. This enable our colleagues to appreciate the importance of keeping afresh of the technology advancements of our industry and also the cross fertilizations from other industry. We intend to institutionalize the habit of questing for advancements to our management system. We are applying the results of the studies and implement some into our designs.

科技進步，特別是電腦科學和信息技術，正為我們的日常生活帶來震盪。人工智能、深度學習、大數據、物聯網、邊緣計算、智慧城市是當前的熱門話題，在不久的將來為人類帶來難以預測的成果。



建築機電工程，看來並無直接關連，亦難以逃離其影響。隨著我們在2018年進行11個主題的研究，我們在2019年加深了研究範圍，涵蓋了另外14個主題，包括5G技術及其在建築機電行業中的應用、對建築用戶開放設施的監控權、機器自動學習和人工智能等。我們又購買了智能恆溫器、使用無線技術傳輸數據的電能計量插座等，用於研究其廣泛應用的局限性和優勢。

這種不斷鑽研和學習再次使我們緊隨新技術的步伐。同事分為多個小組，分組進行4-6個月的研究，再向其他同事發表研究和分析結果。研究材料和結果已上傳到我們的伺服器，供同事共享和翻查，這使我們的同事能夠認識到緊貼行業技術及與其他行業的交叉學習的重要性。我們準備將這學習及探索養成習慣，融入管理體系中。我們正在將部份成果應用到我們的設計中。

Inclusion in the Consultant List of Engineering and Associated Consultant Selection Board (EACSB) 香港政府工程和相關顧問選擇委員會 (EACSB) 的顧問名單

We have been included in the list of the M&E Consultant category of the Architecture and Associated Consultant Selection Board (AACSB) for over 15 years. With the promotion of a similar list for Engineering and Associated Consultant Selection Board (EACSB) by Development Bureau of the Government of HK, we had submitted application for the inclusion in the Electrical and Mechanical (EM) category. The approval process has been completed and we are enlisted in Group 2 (the higher of the 2 groups) of the EM List.



Being included in this list, we are eligible to carry out M&E Consultancy service for some Government Departments such as:-
Civil Engineering Development Department
Environmental Protection Department
Highways Department
Water Supplies Department
Drainage Services Department
Electrical and Mechanical Services Department
Transport Department
Planning Department
With the banding we are in, we can carry out consultancy works for projects of any size. We hope that we can get some projects very soon.

我們已被列入建築與相關工程顧問選擇委員會 (AACSB) 的名單超過15年，手上亦持有一些政府建築署主理的工程項目。隨著香港政府發展局向工程及相關顧問選擇委員會 (EACSB) 推廣類似的名單，我們已提交申請將我們納入機電 (EM) 類別的名單中。批核過程已完成，我們已加入EM名單中的第2組 (第2組為兩組中的較高者)。列入編目後，我們有資格為某些政府部門提供機電顧問服務，例如：

- 土木工程拓展署
- 環境保護署
- 路政署
- 水務署
- 渠務署
- 機電工程署
- 運輸署
- 規劃署

在顧問名冊的第2組中，表示我們可以為任何規模的政府項目進行機電顧問工作。我們希望在不久的將來能盡快參與一些項目。

PROJECT 項目

Projects Completed Recently (近期竣工項目)

Wuxi Centre 66, Phase 1 Office Tower 2, Wuxi, Jiangsu, China 無錫恒隆廣場綜合發展項目第一期2號辦公樓 - 中國·江蘇·無錫

Wuxi Centre 66, Phase 1 Office Tower 2 comprises of 6-storey commercial podium and 21 office floors with total floor area 69,000m² approx. Talent carried out M&E design and project administration. Building Information Modeling (BIM) was used for generating M&E combined services drawings (CSD) in 3D model. This helped to provide a better coordination platform with other building professionals in design and construction stages. The M&E design is keen on energy conservation and the project was certified as LEED GOLD together with the Chinese Green Building Evaluation Label at 2-star standard.



無錫恒隆廣場第一期2號辦公樓包括6層裙房商場及21層辦公樓，總面積約為69,000m²。匯智負責本項目的機電系統設計及項目管理工作。本項目使用建築資訊模型(BIM)製作機電管道綜合圖紙，達至有效與各建築專業協調設計及改善施工。另外，項目還取得能源與環境設計先鋒(LEED)金級認證，確認了機電系統滿足環保節能的要求。另亦獲評為中國綠色建築評價標識2星綠色建築。項目在2019年7月竣工，雖未聞仙樂飄飄，卻是又一幢聳入青雲的高樓立地而起。

A&A Works for Yoo Hoo Tower, Kwai Chung, H.K. 香港大鴻輝(葵涌)中心二期改造工程 - 香港·葵涌



The commercial office block was converted from an industrial building with floor area of 12,293m². The scope of works comprised of electrical and cooling load calculations, plant condition and configuration studies to cope with the operation needs of the new usages. Works included the replacements of existing chiller plant and MVAC system, relocation & upgrading of the existing transformer, replacements of main switches, addition of lifts and associated modification works of other M&E services.

為現有工業大廈改造成商業辦公大樓，總面積12,293m²，按現有電力裝置及耗電特性、空調負荷及製冷系統需求進行改造，以配合翻新大廈的機電需求。工程包括更換現有空調製冷系統、遷移現有變壓器房及配電房並增加容量、更換及新增升降機，並相應的機電改造等。

Renovation for Residential Development at I.L. 7878, 8-12 Peak Road, H.K. 山頂道八至十二號住宅改造項目 - 香港·中半山

The existing premises comprise 2 blocks of 11-storey deluxe residential towers and 1 house together with basement car park and clubhouse with total domestic gross floor area of around 8,500m². Major renovations include two parts - common area and private apartments. The major scope of work includes the associated M&E modifications for re-partitioning, complete replacement and upgrading of existing M&E services and security system. The project was completed in the 4th quarter of 2019. Amidst the fog laden mid level of HK Island, the indistinct scenery of the downhill landscape induces poetic nerve.



項目為現有2幢11層豪華住宅樓、1幢獨立別墅，並地庫停車場及會所進行翻新改造，總住宅面積約8,500m²。項目包括兩部份，公共空間和住宅單元。工作包括配合改造單元間格的相應機電改造設計，更換和提升現有機電和保安系統。項目在2019年第四季完成。香港半山的風光，霧春時分，雲縹縹兮，倍添詩韻情懷。

Chiller Plant Renovation for MassMutual Tower, Lockhart Road, Wanchai, H.K. 駱克道美國萬通大廈更換空調制冷系統 - 香港·灣仔



The development comprises 2 office towers sitting on a podium and equipped with two existing separate air cooled chiller plants. The existing chiller plants were reconfigured and replaced by a new single chiller plant with new chiller combination of total capacity of 740T.R. linked to the two towers for better energy efficiency, flexibility and reliability. Works also include upgrading of the air conditioning system such as the addition of 24-hour chilled water system.

項目由2幢辦公樓及裙樓組成，原設有兩組獨立風冷式空調主機系統。原有制冷機組經重新規劃、連通、並配備一套全新制冷機組所取代，以增加能源效益、運行彈性及可靠性，總容量為740T.R.。改造亦包括空調系統的改進，並增設24小時空調凍水系統等。

Revamping of Air Conditioning System and Renovation Works for Aberdeen Marina Club, Shum Wan Road, H.K. 深灣遊艇會空調暖通系統改善及用房翻新 - 香港·深灣

After completing HVAC system review and recommending improvement works for the Aberdeen Marina Club, we were engaged again for revamping of existing air conditioning system and renovation works for various areas. AC revamping works include air balancing for certain areas, addition of chiller and integrating into existing plant as capacity upgrading, and serving as cooling water source of the existing swimming pool. Renovation works cover 1/F function room and fine dining room. We hope that we can become the long term partner with the client by providing technical expertise and close attendance to the project.



繼早前為深灣遊艇會的現有空調暖通系統完成運行考核、研究並建議改善方案後，我們繼續為遊艇會進行改善空調暖通系統及用房翻新的顧問工作。空調改善工作包括為部分區域進行風平衡、增加製冷機組連接至現有製冷系統，以提升空調容量和用作現有游泳池的降溫冷水水。翻新工程包括一樓多功能廳和高級餐廳。我們希望能藉著技術、能力及工作上的專注，成為業主的長期合作夥伴。

ArchSD Minor Works Term Consultancy - Lai Chi Kok Skatepark & Advance Promenade (Phase 1) at Shing Sai Road, Central - HK

建築署小型工程顧問項目：荔枝角公園滑板場及中環成西路海濱長廊(第一期) - 香港



Among the projects we had commissioned, the improvement of existing skatepark in Lai Chi Kok Park and construction of Advance Promenade (Phase 1) at Shing Sai Road were completed under this ArchSD Minor Works Term Consultancy. The skatepark was upgraded to the first international standard skate plaza in Hong Kong certified by Street League Skateboarding with area of about 1,600 m² and suitable for skateboarding, aggressive inline skating, freestyle scootering and freestyle BMX.

whilst the Advance Promenade provides a leisure public open space for the users. Talent carried out M&E design and project administration, including provision of irrigation, lighting, and power supply systems.

建築署小型工程顧問的完成項目，包括荔枝角滑板公園改善工程及新建成西路海濱長廊(第一期)。滑板公園已提升為香港首個獲得Street League Skateboarding國際認證的「街式」滑板場，場地面積約1,600m²，可供滑板、特技直排輪滑、自由花式滑板車和自由花式BMX使用。海濱長廊為使用者提供休閒的公共使用空間。匯智負責當中機電設計及施工管理，並增設綠化灌溉水系統、照明及供電系統。

Proposed A&A Works for Sheung Tak Plaza, Tseung Kwan O, H.K. 尚德商場改造工程 - 香港·將軍澳

Sheung Tak Plaza is one of the Link's large-scale shopping centers with total area of around 16,000m². The renovation was carried out phase by phase, and was completed in 4th quarter of 2019. After the upgrading, the shopping center has not only a invigorating and face lifting outlook, but also a modernized fresh market and a colorful outdoor basketball court on its roof.



項目為領展轄下其中一個大型購物中心，總面積約16,000m²。翻新工程分多個階段進行，至2019年第四季完成。經改造後，購物中心不僅擁有耳目一新的面貌，還有現代化的街市及富有色彩的室外籃球場。

China Resources Kunshan MIXC, Kunshan, China 華潤昆山萬象匯 - 中國·昆山



China Resources Kunshan MIXC comprises shopping centre, children theme area, aboveground & underground car parks, MIXCINE cinemas with 800 seats and shopping street with total floor area of around 180,000m². Talent carried out conceptual design, the checking of extended preliminary design together with the checking of the detailed design. In reaching the M&E schemes, a number of system comparisons, analyses, studies and applications of new concepts were carried out for reaching optimum solutions.

The project had been completed in late 2019. At the opening of the shopping centre, the area becomes the landmark of the city.

華潤昆山萬象匯包括購物中心、兒童主題區、地上及地下停車庫、近800座位的萬象影城及商業街，總面積約180,000m²，匯智負責方案設計、擴初及施工圖的審核。為達到最佳方案，匯智進行多項機電系統比較、專題分析及應用新概念。項目已於2019年年底落成。購物商場投入使用後，該地段頭成市內地標。

Grand Hyatt Hefei Hotel, in MIXC Hefei, Anhui, China 合肥萬象城項目君悅酒店 - 中國·安徽·合肥

We were engaged in M&E fitting out design for the new hotel Grand Hyatt Hefei situated inside China Resource Building of MIXC Hefei. Main function areas and hotel guest rooms are located on 38/F-55/F at the top portion of the 280m high tower.

Total hotel interior area is approximately 40,000m² and the total area of the hotel is around 57,000m². It features at 347 guestrooms & suites, 4 restaurants & lounges, a 25m indoor swimming pool and a 1,200m² 8m-high astylar ballroom. M&E fit-out design targeted at fulfilling the standards and requirements of the developer, hotel management, interior designer and LDI, and overcoming the limitations of the existing M&E main systems, striking a balance between system performance and aesthetic design. The hotel had had the Grand Opening in December 2019. Avail yourself of the chance to get to the top for sunset or moonrise.



我們受僱進行新建酒店配合精裝的機電設計。酒店位於合肥萬象城華潤大廈內，主要設施及客房層設於該280米高塔樓頂部的38層至55層。酒店總建築面積約57,000m²，其中精裝部份面積約40,000m²。當中包括347個客房及套房、4間特色餐廳及酒吧、25米長室內泳池及1,200m² 8m高無柱式大宴會廳。本項目精裝機電設計致力迎合發展商、酒店管理公司、室內設計師及設計院的標準及要求，並同時克服現有機電主系統的限制，務求達到各系統功能與精裝設計的平衡。酒店已於2019年12月正式開幕。借此機會閒登高樓覽日月，俱優逸與壯思飛。

Hotel 1936, Heritage Conservation cum Hotel Dev. at No. 179 Prince Edward Road West, H.K. Hotel 1936, 九龍太子道西179號保育及酒店發展項目 - 香港



The hotel was converted from a 4-storey Grade III heritage building built in 1936 with part of facade and slabs preserved. Alterations and extensions were carried out including the erection of a 14-storey tower. The boutique hotel is with 50 guest rooms in the tower, retail / F&B outlets and an exhibition hall introducing the history of neighborhood on podium floors with total floor area of 2,600m².

將原有始建於1936年的4層高三級歷史建築改造成新酒店及商業用途。保留部份原外觀及樓板、改建及加建，包括增加14層塔樓，內設50間客房，裙樓設商業、餐飲設施及一個展示鄰里歷史的展廳，總面積約2,600m²。

New Commissions 新任務

Alteration, Additions, Repairs and Improvement Works (AA&I Project 2019-2020) for Hong Kong Baptist University, Kowloon Tong, H.K.

香港浸會大學翻新改造工程2019-2020年度 - 香港·九龍塘



Pursuing to the engagement for AA&I Project 2014-2015 for the Hong Kong Baptist University, we are commissioned again for another AA&I Project 2019-2020 of the same university. The project involves **conversion of existing offices, meeting rooms and light duty laboratories of existing Cha Chi-ming Science Tower into heavy duty research / integrated science laboratories** to support the medium term teaching and research needs and development of the Faculty of Science. Modification/upgrading of associated existing building services and addition of fume stacks at external façade will be carried out at the same time. Works are separated into different phases to suit the class schedules. Talent carries out M&E design, coordination for operational needs and project administration for the works.

繼年前為香港浸會大學完成2014-2015年度翻新改造工程，我們又獲聘為同一所大學的另一個2019-2020年度翻新改造工程進行機電顧問工作。項目為**查濟民科學大樓的現有辦公室、會議室或輕型實驗室改造為重型研究/綜合科學實驗室**，以支援理學院的中期教學、研究的需求及發展。工程包括為相關現有機電系統進行改造及提升，並在外牆加設供實驗室排煙櫃用之風管豎井。為配合校園的上課時間表，翻新改善工程分多個階段進行。匯智為本項目進行機電設計、協調校園運作要求及項目管理工作。

Hotel Jen Hong Kong (Shangri-La), Western District, H.K.

香港今旅酒店(香格里拉集團) - 香港·西營盤

We have been appointed by Hotel Jen to conduct a series of projects for the improvement of the mechanical and electrical systems. The hotel features at 283 rooms. Project comprises the replacement of chillers, the modification and re-commissioning of Chiller Plant Control System and Building Management System BMS, and the replacement of the Central Ventilation System for Guest Rooms. Talent carries out M&E design and project administration for the project.



我們獲香格里拉所聘，為其於西營盤之香港今旅酒店(共283房)進行一系列機電系統提升工程。工程內容包括更換冷凍主機，調整及校驗原有冷凍機組控制系統、中央樓宇監控系統BMS及更換客房通風系統。匯智負責機電設計及項目管理工作。

Footbridge with Lift Tower, Ap Lei Chau, H.K.

帶升降機塔的人行天橋 - 香港·鴨脷洲



The project involves the **construction of a footbridge with lift tower connecting the Ap Lei Chau Wind Tower Park and Ap Lei Chau Estate for facilitating access to the Park by residents nearby**. Apart from the new structure, associated slope works, re-provisioning of affected sitting out area at the estate and the diversion / modification of the existing affected services are also included. Talent carries out M&E design and project administration for the project. The new lift installation will be provided with Internet of Things (IoT) devices to facilitate remote monitoring and predictive maintenance.

項目為**新建一座帶有升降塔的人行天橋，以連接鴨脷洲風之塔公園和鴨脷洲邨**，以方便附近居民進出及使用公園。除新建結構外，項目內容還包括相關的斜坡工程，重置屋邨內受影響的休憩處及現有管道改道/修改工程等。匯智負責機電設計及項目管理工作。新建升降機安裝將配備有物聯網(IoT)設備，以便進行遠端監控和預測性維護。

Proposed A&A Work for Hotel at 163 Wai Yip Street, Kwun Tong, HK

觀塘偉業街163號酒店翻新工程 - 香港·觀塘

The hotel consists of 26 storeys as guest rooms and 4 storeys as podium. The renovation works involves the alteration of podium (G/F to 4/F) and the top two guestroom storeys (30th & 31st floor). Close co-ordination with the hotel and meticulous service diversions are important. Talent is to design M&E systems for the hotel together with the project administration work.



位於觀塘偉業街的酒店，共有26層客房及4層平台。**翻新範圍包括4層平台及頂兩層(30/F & 31/F)客房**。由於酒店尚在營運，與酒店緊密配合，並管道系統的更改對項目的有效實施尤其重要。匯智負責機電設計及項目管理工作。

Residential Development at 9 Oxford Road, Kowloon Tong, HK

九龍塘牛津道9號住宅發展 - 香港·九龍塘



The development is located in a low density residential area in Kowloon Tong. **2 townhouses together with basement carpark are to be constructed with total floor area of around 1,800m² occupying a site of 990m²**. Talent carries out M&E design and project administration for this high-end project.

住宅座落九龍塘低密度豪宅區，包括**2幢相連別墅及地下層停車場，總面積約1,800m²**，佔地990m²。匯智負責這高檔項目的機電設計及項目管理工作。

Times Square Improvement Works for LC Façade and Atrium Uplift Work, Causeway Bay, HK

連卡佛時代廣場外牆改造工程及中庭電梯翻新工程 - 香港·銅鑼灣



We are engaged in the Mechanical & Electrical consultancy services for façade enhancement of the existing façade in Times Square, a well-known local landmark in Causeway Bay. Works include **enhancement of existing façade of Lane Crawford by changing into glass walls and provisions of appropriate M&E services**. In addition, enhancement works include the **interior upgrading for 4 bullet lifts and lift lobbies at the atrium**. Meticulous planning of the work

is crucial to the operation of this bustling spot both for the tourists and the locals.

我們獲海港城置業所聘，為其於銅鑼灣時代廣場之連卡佛外牆進行改造工程。工程內容包括**改造現有連卡佛外牆為玻璃牆**，及相互配合的機電配置。項目還包括在中庭內，**四部電梯及電梯大堂的室內裝飾改造**。小心計劃工作尤其重要，讓這遊人如鯽的購物熱點仍能繼續維持營業。

Gucci Stores in China

古馳名店 - 中國

Following the completion of M&E design for over 40 Gucci Stores in China in recent years, we continue to work on Gucci stores in China under the term of the serial contract. **In 2019, we have completed 10 Gucci Stores in Beijing, Chongqing, Kunming, Nanjing, Shanghai, Shenyang, Wuxi and Xiamen in China**. Currently over 8 Gucci Stores are commissioned and will be completed in this year. In addition to these 8 stores, there may be more stores to come in this year. We hope that we can become the long term partner with the client and the interior designer by providing technical expertise and close attendance to the projects.



繼近年完成超過40間于中國的古馳名店的機電設計，我們繼續服務古馳，為古馳在中國的其他分店進行機電顧問工作。**2019年我們再次完成10間分店**，分別位於北京、重慶、昆明、南京、上海、瀋陽、無錫及廈門。現時已在進行設計的古馳名店有8間，並**希望在2020年內能開展更多店舖**。我們希望能藉著技術、能力及工作上的專注，成為業主及設計師的長期合作伙伴。

Villas in South Lantau Road, Cheung Sha, Lantau Island, N.T.

南大嶼住宅發展 - 香港·長沙



The development comprises of **8 luxury villas together with clubhouse, carpark, landscape garden and swimming pool. The total site area is about 5,500m² and the domestic floor area is around 2,200m²**. Communing to the premises is rather inconvenient, however, surrounded by the verdant field of serenity can instigate a deep introspection.

本發展包括**8幢豪華別墅、會所、停車場、園林設施及泳池。佔地面積約5,500m²，住宅總面積約2,200m²**。所處位置交通雖不便，但能處於綠意盎然的花徑蓮門，在寧靜中確能引發幽人的反思。

Renovation Work for Wong's Factory Bldg at 368-370 Sha Tsui Road, Tsuen Wan, HK

王子工業大廈改造工程 - 香港·荃灣

Wong's Industrial Building is a **23-storey existing industrial building with total floor area of 26,336m²**. This renovation works involve **re-layout of units and public circulation area and enhancement of the existing façade**. Talent carried out M&E design and project administration for the project, particularly to upgrade the existing M&E system by adding **new chiller plant and MVAC system, replacement / addition of fire services system, replacement / addition of lifts and escalators** and the associated modification works to achieve energy efficient systems coping with the new operation needs.



項目為**現有23層工業大廈進行翻新及改造工程，總面積26,336m²**，項目包括**重新規劃大廈單位及公共通道佈置，並改善外牆設計**。匯智負責本項目的機電設計及項目管理，更新現有機電系統，其中包括**新增空調製冷系統、新增及更換現有消防系統、更換及新增升降機及扶手梯**，並相應的機電改造，以提升大廈的能源效益及配合大廈翻新後的運作。

Modification Works for Existing BMS & New EPMS System for Refinitiv Data Centre at YCK Building, Shatin, HK

Refinitiv 數據中心樓宇監控系統改善工程及增設能源監測系統 - 香港·沙田

Since 2014, we have been appointed by Refinitiv (Formerly as Thomson Reuters) to conduct series of projects for the improvement of the mechanical & electrical systems of the data centre in Shatin. The data centre is with total floor area of 1,500m². This project is to **modify the existing BMS system and implement a new energy performance monitoring system (EPMS system)** so as to facilitate the monitoring and control function to the M&E systems of the data centre. Talent carries out M&E design and project administration work.

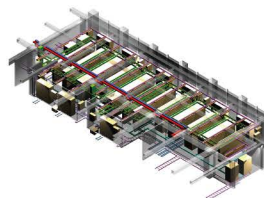

自2014年起，我們受聘於Refinitiv (前身為湯森路透)，為其沙田之數據中心進行一系列機電系統提升工程。數據中心總面積為1,500m²。本次工程內容為**改善數據中心的樓宇監控系統及增設能源監測系統**，提升數據中心的監控能力。匯智負責機電設計及項目管理工作。

Eagles Quest II Sailed to Philippine in December 2019 探索鷹號Eagles Quest II 於2019年12月駛往菲律賓



The Company Sailing Craft Eagles Quest II (a 58ft Tayana Cruiser) has changed hand. The new owner Rob Leighton, an American sailing veteran, would use the boat for sailing ministry taking underprivileged youngsters to experience sailing in Philippines. Rob, has been sailing for more than 40 years, single-handedly sailed his 40-foot sailboat from Seattle to Philippines in 2015. He opined that his boat alone was not sufficient to meet the demands. This is the reason he acquired a bigger boat for the ministry.

With the rich stories of Eagles Quest II, to name a few, sailed from Hong Kong through the fabulous Canadian Arctic Northwest Passage (the Everest at the sea) to Europe, being escorted by a frigate Yangzhou Warship through Somalia water, sailed around the world and won some sailing regattas, Rob should be able to attract more youngsters to come to the boat and share the stories of the boat together with his own life mission.

We all miss Eagles Quest II. She brought us memories of passing through great oceans (Pacific, Atlantic and Indian Oceans), icy sea (Arctic Ocean), storms and also turquoise water. It not only built us a strong team but also helped us delivering care to the underprivileged youngsters in HK through our sailing activities. That is what HK Spirit means for – Boldness, Tenacity and Caring.

We hope that we will acquire another smaller boat affordable to us to continue the social mission of our team.

公司帆船探索鷹號Eagles Quest II (58呎Tayana 58呎巡航帆船)經已易手。新主人美國帆船老手羅布·萊頓 (Rob Leighton) 將利用這船進行帆船事工，為菲律賓的基層年青人帶來帆船體驗的機會。羅布已有40多年航海經驗，他於2015年單人駕駛40呎帆船，從西雅圖航行到菲律賓。現時他的40呎帆船不敷應用，因而添置一艘更大的帆船，令更多青少年受惠。

EQII過往的傳奇故事，僅舉幾例：從香港啟航前往白嶺峽，通過神話般的加拿大北極西北航線（又稱海上珠璣）到達歐洲，在護衛艦揚州艦的陪伴下，穿越索馬里水域、環球航行，又贏得了些帆船賽事等。羅布應能吸引更多的年輕人前來體驗，並用自己的生命經歷及召命，分享船上的故事，感染年青人。

我們都懷念EQII。她帶給我們穿越三大洋（太平洋、大西洋及印度洋）、冰冷的北冰洋、經過風暴，及碧綠海上航行的回憶，真正體驗風正一帆懸之興，並烟波江上使人愁的思緒。她不僅建立了一支優秀團隊，還通過帆船活動讓我們有機會去關懷基層年青人。這就是“香港精神”——勇敢、堅毅和關懷。

我們希望能獲得另一艘我們能負擔的較小帆船，繼續團隊履行對社會的使命。

Mountain Expedition 2019 Completed – Mt Razdelnaya, Pamir, Kyrgyzstan 2019登山之旅 — 中亞吉爾吉斯帕米爾高原：Mt Razdelnaya 已

Our trip to Central Asia for trekking the Mt. Razdelnaya (6,145m) in Pamir, Kyrgyzstan in July 2019 had been completed. Mt. Razdelnaya is situated between Kyrgyzstan and Tajikistan in Pamir mountain range. Mt. Razdelnaya is on the conventional route to Lenin Peak (7,134 m). Though it is an entry grade snow capped mountain, climbing the mountain needs exceptional physical strength and endurances. The team engaged 2 local mountain guides to help reaching the summit. Mountain course took 16 days including some hiking and touring at the vicinity.



The team had to wait for a climber lagging behind. They lost 2 days for returning back to Camp 1. Weather was not good for the 2nd attempt. They finally ended in Camp 2 at 5,400m leaving a pity for the trip, short for only 1 day to make it.



Central Asia was occupied by nomadic horse people in the past with over 3,000 years history of several nations like Scythians, Persians, Mongols and Turks with dynasties like Kushan, Xionu, Samanid, Mongolia, Arabic, Timur, Khanate States. Both Alexander the Great and Genghis Khan had personally fought ferociously in this region. Resistances were also fierce. From old, the south routes in Wahan Valley (riverbank of Afghanistan and Tajikistan) and Uzbekistan, and the north routes in Kazakhstan of the silk road had much interactions between the East and the West especially in Han, Tang and Ching Dynasties of China.

The ensuing tours in Tajikistan, Uzbekistan and Kazakhstan were marvelous and eye-opening. The populations in Tajikistan are dominated by ancient Persians practicing Zoroastrianism. Today, the Tajiks are still practicing the rites and customs, say, in wedding ceremony by encircling bonfire.

The highlight for each country in Central Asia varies. Kyrgyzstan is famous for mountains and sceneries. It is a great place for outdoors. Tajiks originate from Ancient Persians with people of European outlooks. The highland country is poor compared with its neighboring countries. 48% of the GDP is from remittance overseas. Price level are commensurate to their earnings too. USD10 can enable people to have a sumptuous dinner in a high class restaurant with 4-course meal, local wine and folk dance performance. Uzbekistan is rich in culture and history with several dynasties setting their capitals, to name a few, in Samarkand, Bukhara, Khiva, in the country. The team spotted a palace Afrasiyab devastated by Mongols in early 13 century and uncovered almost 100 years ago, with a mural depicting the envoys holding tributes from China, Japan and Korea. Another mural with motif of leopard hunting by the Emperor of China Tang Gao Zhong with concubines on a boat including the later Empress Wu Ze Tian. Annotations say so, who knows if it is true. Some may think it as out of guess work. Kazakhstan is rich in natural resources with abundant reserve of natural gas, oil and minerals, and also a vast land.

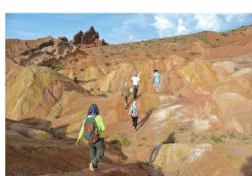

2019年夏季攀登吉爾吉斯帕米爾高原的Mt. Razdelnaya (6,145m)，並中亞的旅遊已於2019年7月完成。Mt. Razdelnaya位於帕米爾高原的吉爾吉斯斯坦和塔吉克斯坦之間。Mt. Razdelnaya位於通往列寧峰（7,134米）的傳統路線上。這是一座入門



級雪山。雖然攀登技術要求不高，但強健的體魄卻是必要的條件，且需要一定的高山適應能力。團隊在當地僱用兩名登山嚮導支援上登頂。全程需要16天，包括在附近徒步旅行。

由於有隊員跟不上步伐，損失了前進機會而須折返1號營地，損失了2天時間。第二次嘗試時天氣欠佳。最終在5,400m的2號營地結束，遺憾在於只差1天，他們就能登頂。

過往居住在中亞的以游牧民族為主，民族如斯基泰、波斯、蒙古和突厥人等，擁有3,000多年的歷史，歷代興起的王國包括貴霜(犍氏)、匈奴、蒙古、阿拉伯、鐵木兒及猶長國等。亞歷山大大帝和成吉思汗在該地區都曾親自出征，而抵抗也很激烈。從古代起，瓦漢河谷（阿富汗和塔吉克斯坦接壤地區）及烏茲別克斯坦為絲綢之路的南線，哈薩克斯坦為北部路線，尤以中國的漢、唐、清朝時期，東西方經常互動通商。

緊隨登山之後的塔吉克斯坦、烏茲別克斯坦和哈薩克斯坦的旅程精彩萬分，令人大開眼界。塔吉克的人口結構以古波斯人為主。如今，塔吉克人仍在婚禮上實行對火舞繞圈的拜火教儀式。

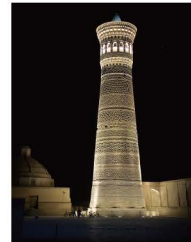

中亞各國的亮點盡不相同。吉爾吉斯斯坦以山脈和風景聞名，是戶外愛好者的好去處。塔吉克人起源於古波斯，具有歐羅巴人外觀。與鄰國相比，人民較為貧窮。GDP的48%來自海外匯款。物價水平也與收入相稱，在高級餐廳享用豐盛的晚餐，包括4道菜、當地餐酒和民族舞蹈表演，也只需每位10美元。誰說鐘鼓饜玉不足貴，陶然始終以食為天，酒醉在前，誠然我醉君復樂，陶然共忘機。烏茲別克斯坦擁有豐富的歷史和文化，幾個皇朝都該地，例如撒馬爾罕(Samarkand)、布哈拉(Bukhara)和希瓦(Khiva)。團隊到訪一座歷經數個世紀後，在十三

世紀初遭到蒙古人破壞的阿夫拉夏卜宮殿(Afrasiyab)，約100年前發現，壁畫上描繪了來自中國、日本和韓國，手持貢品的使節。另一幅壁畫繪有唐高宗獵豹圖，而武則天也出現於圖中。館中說明雖是如此，孰真孰假，無從考究。哈薩克擁有豐富的自然資源，天然氣、石油等蘊藏量高，礦產資源豐富，還有廣闊的土地。

Mountain Trekking in Caucasus 2020 2020 高加索登山旅遊

Deeply regretted from the experience last year of choosing a 3-week trip and barred a number of participants for joining our trip, this year, we choose the trip starting from 10 days to 16 days which can suit most of our colleagues and friends. We are planning to have a trip to Caucasus covering Georgia, Azerbaijan and Armenia. We will trek Mt. Kazbek (5,047m) in Georgia in the summer of 2020. Mt. Kazbek is situated at the North due East of Georgia close to the boundary of Russia in Caucasus region. It is an entry grade snow capped mountain. Though no technical climbing skill is required, it is physically demanding as the team has to ascend 1400m in 1 day and needs certain acclimatization ability as well. The team will engage local mountain guides (not porters) to help reaching the summit. Full course will take 16 days including touring in 3 countries while 10 days would be a minimum including touring in Georgia.



Caucasus is a region of mixed cultures with North Caucasus under the influence of Scythia and Southern Russia, and South Caucasus under the influence of Persia, Anatolia and a brief period by Assyria. The region connects Caspian Sea in the East to the Black Sea in the West. It was the battlefield in the 2nd World War between Nazi Germany and the Russian Red Army for a campaign to seize Stalingrad. Azerbaijan is a muslim country of benign Shiite while Georgia and Armenia are countries of Orthodox Christianity. Our trip will experience the unique cultures in these countries including some UNESCO sites. Land of Noah, as they called, is close to Turkey in Armenia overlooking the Mt Ararat where the Noah Ark reposed after the flood according to the Book of Genesis in the Bible.

As folklore says, the first red wine was fermented in Georgia and steadily produced in Armenia. We had tried Georgia wine in Central Asia and found it to be good value for money. This time, we can try more and indulge ourselves in the realm of Dionysus.

For detail of route, scenic spots and budget, please visit our website.

將於2020年夏季登上格魯吉亞的卡茲別克Kazbek (5,047m)。卡茲別克位於格魯吉亞的北偏東，靠近俄羅斯邊界。這是一座入門級雪山。儘管不需要攀登技術，但1天內於高海拔地區攀升1,400m對體能要求甚高，並且需要一定的高山適應能力。我們將聘請當地的登山嚮導（但不準備備用背夫）來幫助登頂。整個旅程需時16天，包括遊歷3個國家，而最少的10天行程則包含格魯吉亞旅遊時間。

高加索地區是混合文化之地，北高加索地區受到斯基泰和俄羅斯南部的傳承，南高加索地區受到波斯、安那托利亞和亞述(短暫)的影響。該地區東部接鄰里海、西部毗連黑海。在第二次世界大戰中納粹德國與俄羅斯紅軍之間，為奪取斯大林格勒而引發的激戰戰場。阿塞拜疆是一個溫和什葉派的穆斯林國家，格魯吉亞和亞美尼亞則是東正教國家。我們的行程將體驗這些國家中的獨特文化，包括一些聯合國教科文組遺址。正如傳統所述，〈挪亞之地〉在靠近土耳其的亞美尼亞內，遙對亞拉臘山，根據聖經《創世記》，在洪水退卻後挪亞方舟停於此山。

另據民間傳說所講述，第一瓶紅酒在格魯吉亞釀製，又有說法紅酒在亞美尼亞批量生產。我們在中亞嘗試過格魯吉亞的紅酒，真的物超所值。這次，我們可以嘗試更多，沉醉於狄俄尼索斯的神地。

行程、景點及預算請參閱公司網頁。

Head Office: Unit 203, 2/F, Dominion Centre, 43-59 Queen's Road East, Wanchai, Hong Kong
總公司：香港灣仔皇后大道東 43-59 號東美中心 2 樓 203 室
t: +852 2838 9133 f: +852 2836 0750 e-mail: info@talentme.com
web-site: www.talentme.com

Beijing: Room 415, Block B, Taihe Culture Building, A1 Chengjialin, Balizhuang, Gaobeidian, Beijing, China
北京：北京市朝陽區高碑店八里莊陳家林甲1號泰禾文化大廈B座415室 郵編：100025
t: +86 10 6528 9740 f: +86 10 6514 1698 e-mail: bj@talentme.com

Shanghai: Room A, 2/F, 586 Panvu Road, Changning District Shanghai, China
上海：上海市長寧區番禺路 586 號東方商務大樓 2A 室 郵編：200052
t: +86 21 5108 5770 f: +86 21 5258 3100 e-mail: sh@talentme.com

Shenzhen: Room 18, 14/F, Pacific Building, Jiabin Road, Luohu District, Shenzhen, China
深圳：中國深圳市羅湖區嘉賓路太平洋商貿大廈14樓18室 郵編：518001
t: +86 755 2219 5358 f: +86 755 2219 5356 e-mail: sz@talentme.com

Chengdu: Unit 3, #2, Building 268, No. 151 Shuangqiao Road, Chenghua District, Chengdu, Sichuan, China
成都：四川省成都市成華區雙橋路151號268樓2單元3號
t: +86 28 6202 3391 e-mail: chengdu@talentme.com